

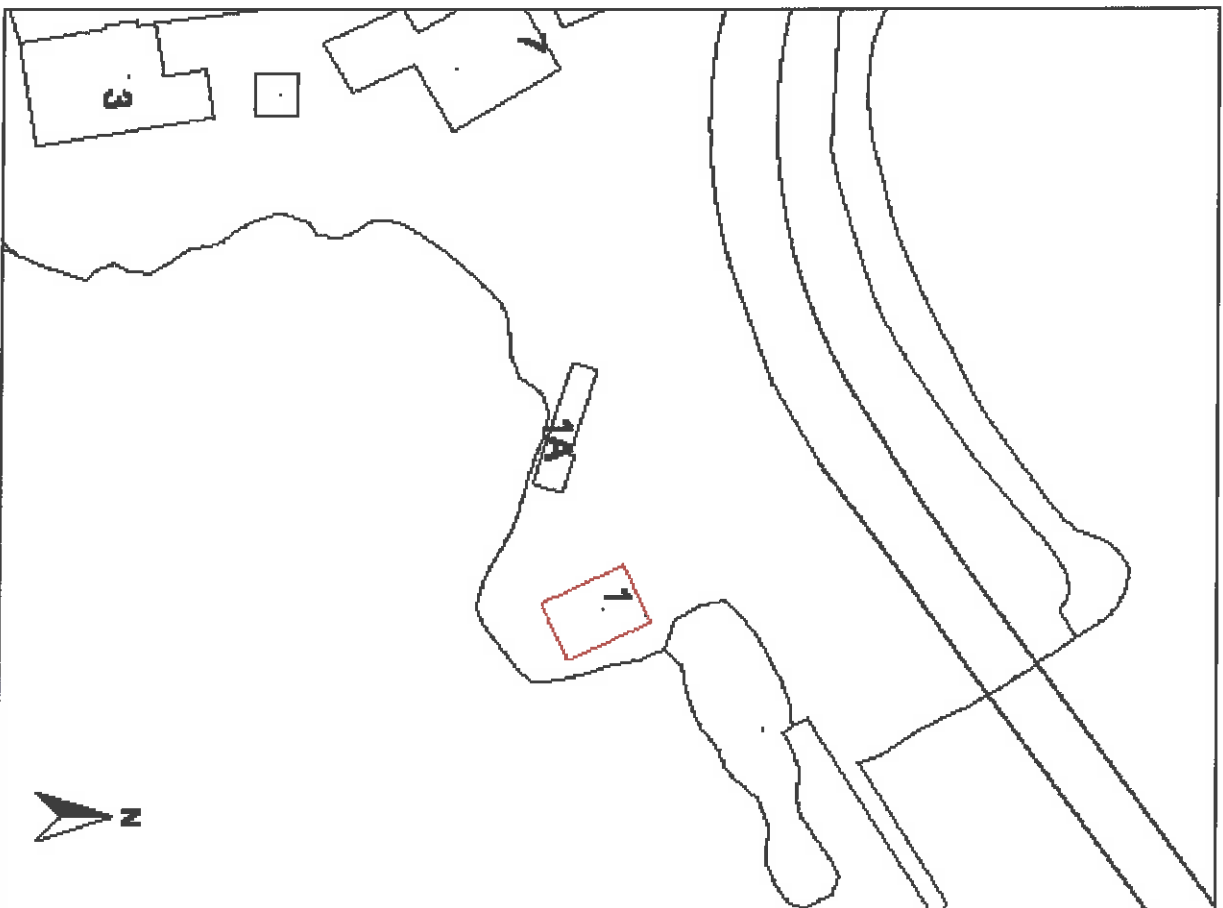

GOVERNMENT OF BERMUDA

Ministry of Works and Engineering

Department of Lands, Buildings and Surveys
Lease Plan



No. 1 Mangrove Bay Road

Date: May 2008
Scale: 1: 1000

Drawing No. 5510/D/04/248
File No.

Endranted Area = 0.007 ha (0.017 acres)
For identification purposes only