

ISSUED FOR:

AMENDMENTS:

NO:	REVISION	APP	DATE:
A	PLANNING		10/OCT/16

SCALE: 1/16"=1'0"

SURVEY	
PREPARED BY: RS	DATE: 10/OCT/16
DESIGN	
PREPARED BY: RS	DATE: 10/OCT/16
CHECKED BY: RS	DATE:
DRAWING	
PREPARED BY: RS	DATE: 10/OCT/16
CHECKED BY: RS	DATE: 10/OCT/16

APPROVED BY:

PROJECT NUMBER:
50816

PROJECT NAME:

**PROSPECT
PUMP STATION**

FORT PROSPECT
14 HEADQUARTERS HILL
DEVONSHIRE

DRAWING FILE NO:
K:WATER SECTION\PROSPECT\DATA MONITORING

SHEET TITLE:

**PROPOSED
SITE PLAN**

SHEET NUMBER:

E4

REVISION

1

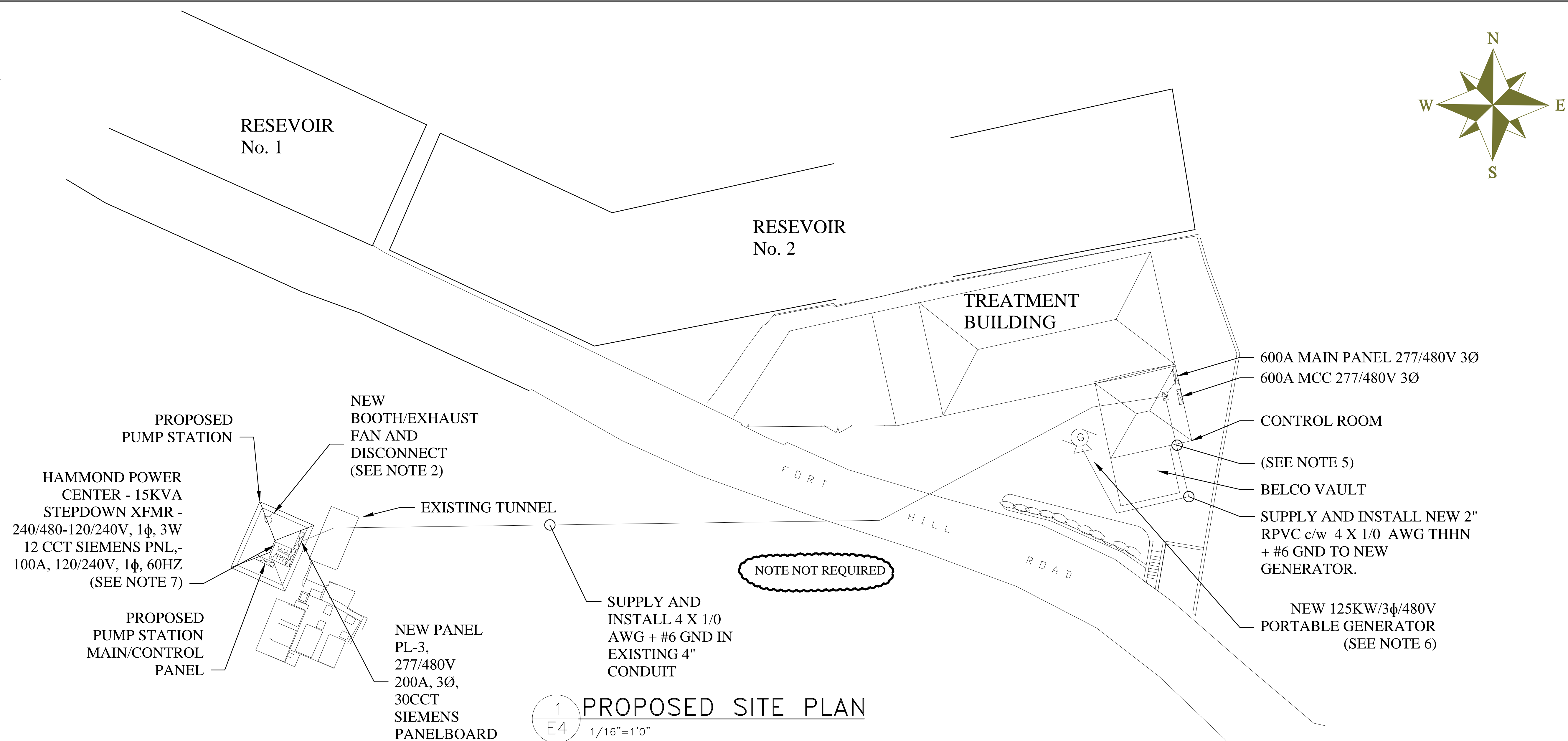

NOTES:

1. THE ENTIRE ELECTRICAL INSTALLATION SHALL CONFORM TO THE BERMUDA BUILDING CODE, NATIONAL ELECTRIC CODE (2008), NFPA 72 (2010), AND NFPA 101 (2012). REFER TO ELECTRICAL SPECIFICATIONS.
2. ALL ELECTRICAL DEVICES SHOWN DASHED ARE EXISTING.
3. ALL DEVICES SHOWN SOLID ARE NEW DEVICES AND EQUIPMENT TO BE PROVIDED BY THE ELECTRICAL CONTRACTOR.
4. INSTALL NEW EXHAUST FAN PROVIDED BY OWNER. SUPPLY AND INSTALL NEW DISCONNECT FOR EXHAUST FAN.
5. ELECTRICAL CONTRACTOR SHALL BE RESPONSIBLE FOR FIRESTOPPING ALL PENETRATIONS.
6. 125KW PORTABLE GENERATOR SHALL BE SUPPLIED BY PUBLIC WORKS AND INSTALLED BY THE ELECTRICAL CONTRACTOR. ELECTRICAL CONTRACTOR SHALL SUPPLY AND INSTALL A NEW KOHLER AUTOMATIC TRANSFER SWITCH FOR THIS PORTABLE GENERATOR.
7. HAMMOND POWER CENTER SHALL BE SUPPLIED BY PUBLIC WORKS AND INSTALLED BY THE ELECTRICAL CONTRACTOR.