

**ANNEX D - ELECTRIC BUS CHARGING STATIONS  
SITE AERIAL PHOTO**



AERIAL PHOTOGRAPH 2012 IMAGERY  
NOT TO SCALE

DEPARTMENT OF PUBLIC TRANSPORTATION  
26 PALMETTO ROAD  
DEVONSHIRE, DV 05  
BERMUDA





ANNEX D - ELECTRIC BUS CHARGING STATIONS  
AERIAL PHOTO WITH CONTOURS AT 1M INTERVALS

AERIAL PHOTOGRAPH WITH 1m INTERVAL CONTOURS  
NOT TO SCALE  
2012 IMAGERY

DEPARTMENT OF PUBLIC TRANSPORTATION  
26 PALMETTO ROAD  
DEVONSHIRE, DV05  
BERMUDA



**ANNEX D - ELECTRIC BUS CHARGING STATIONS  
PLANNING ZONING & PROTECTION AREAS**

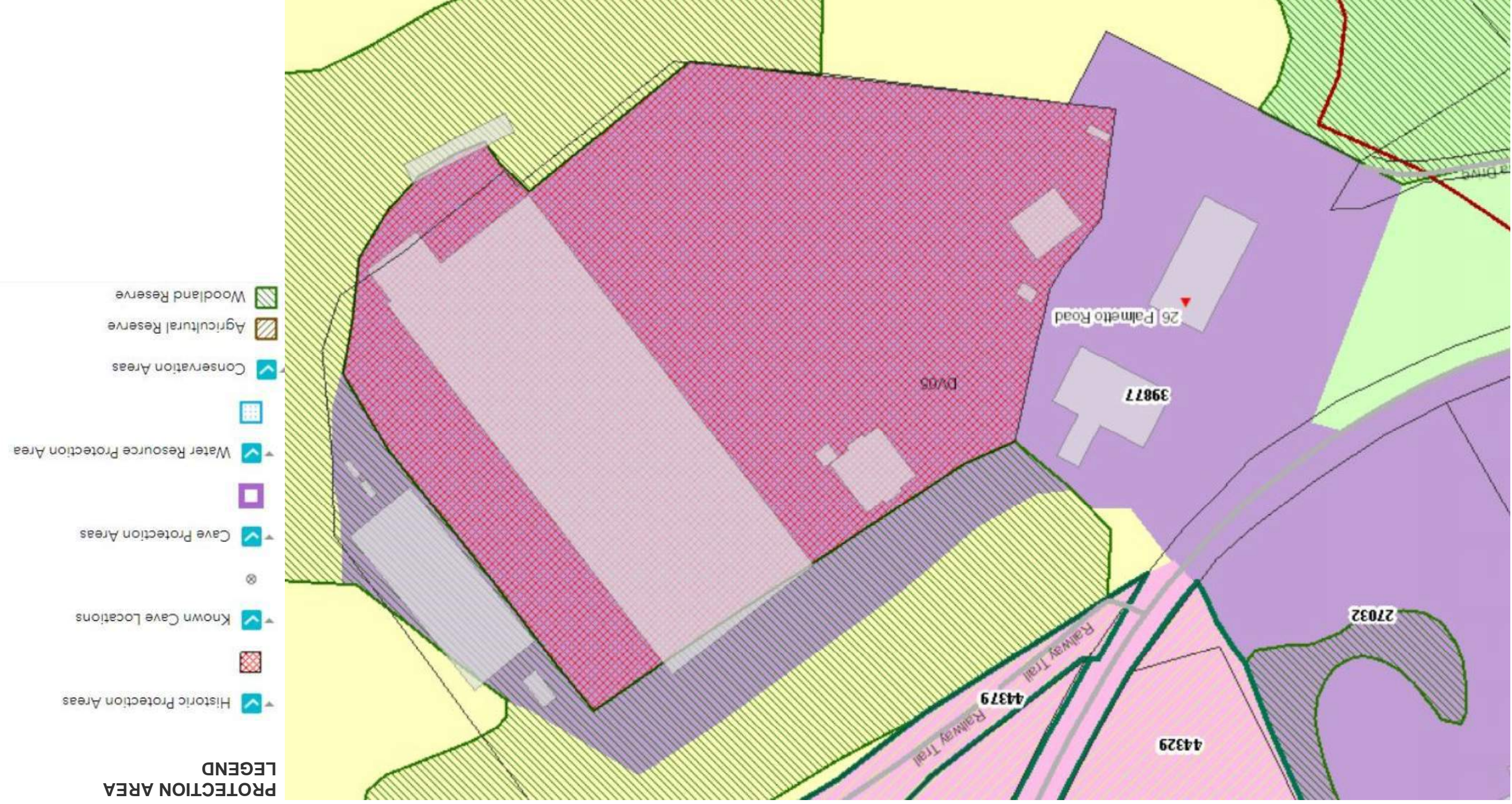

**ZONING  
LEGEND**

- Residential 1
- Residential 2
- Rural
- Commercial
- Institutional
- Industrial
- Tourism
- Mixed Use
- Airport
- Open Space Reserve
- Coastal Reserve
- Recreation
- Park
- Nature Reserve
- Special Study Area
- City Plan 2015/2001

DEPARTMENT OF PUBLIC TRANSPORTATION  
26 PALMETTO ROAD  
DEVONSHIRE, DV05  
BERMUDA

ZONING PLAN  
NOT TO SCALE

**PROTECTION AREA  
LEGEND**

- Historic Protection Areas
- Known Cave Locations
- Cave Protection Areas
- Water Resource Protection Area
- Conservation Areas
- Agricultural Reserve
- Woodland Reserve





GOVERNMENT OF BERMUDA  
Ministry of Environment & Planning

Department of Land Surveys & Registration

P.O. Box HM1364 Hamilton HMFX Bermuda  
Phone: (441) 295-5151 Fax: (441) 295-5658

GENERAL NOTES:

1. SURVEY GRID IS BM2000 IMPERIAL.
2. LEVELS ARE IN FEET ABOVE ORDNANCE.
3. BUILDING OUTLINES ADAPTED FROM THE 2012 TOPOGRAPHIC MAPPING DATABASE.
4. SURVEY STATION COORDINATES

STN	EASTING	NORTHING	LEVEL
1	1800396.42	440317.55	118.9
2	1800352.14	440209.27	112.2

THIS PLAN MUST NOT BE ALTERED IN ANY WAY UNLESS  
AUTHORISED BY THE SENIOR LAND SURVEYOR  
ONLY AUTHENTICATED COPIES OF THIS PLAN SHOULD BE USED  
© COPYRIGHT - BERMUDA GOVERNMENT

ISSUED FOR:

NO.	REVISION	APP	DATE:

SCALE: 1" = 20'

SURVEY  
PREPARED BY: C. SHANE MCILWAIN  
DATE: 23/04/21  
DESIGN  
PREPARED BY: C. SHANE MCILWAIN  
DATE: 23/04/21  
CHECKED BY: DATE:  
DRAWING  
PREPARED BY: C. SHANE MCILWAIN  
DATE: 28/04/21  
CHECKED BY: S. PATTERSON  
DATE: 28/04/21  
APPROVED BY: S. PATTERSON - SENIOR LAND SURVEYOR  
PROJECT NUMBER: 30/241/33 TASK 84818  
PROJECT NAME: SITE SURVEY OF  
PTB BUS DEPOT  
FORT LANGTON  
#26 PALMETTO ROAD  
DEVONSHIRE

DRAWING FILE NO: CIVIL 3D 2018  
PMS\SURVEYPROJECTS\3024133\84818

TOPOGRAPHIC  
SURVEY

SHEET NUMBER: 4834/006/05

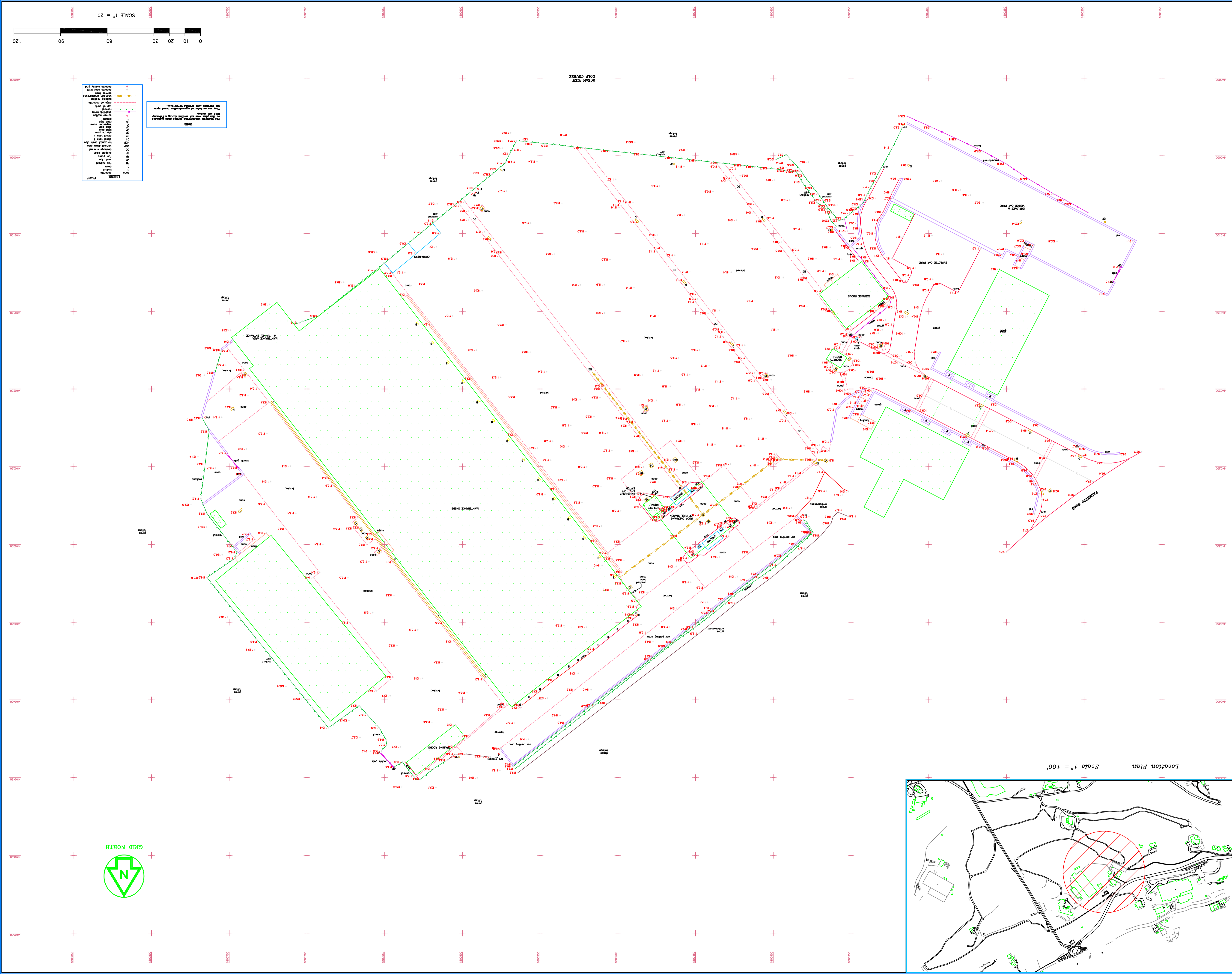
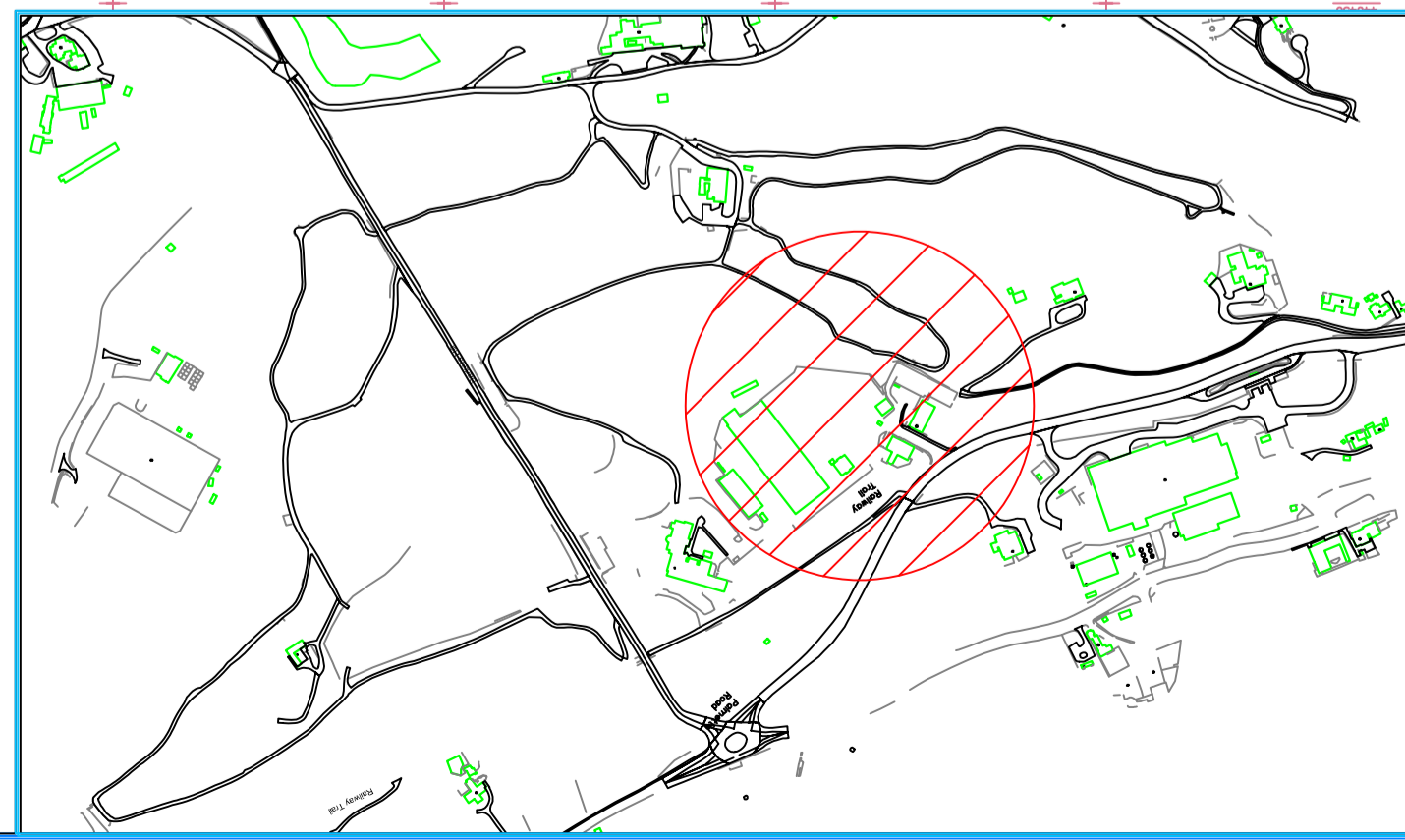

LEGEND

SYMBOL	DESCRIPTION
(Symbol)	Proposed Bus Charging Station
(Symbol)	Proposed Electric Vehicle Charging Station
(Symbol)	Proposed Pedestrian Path
(Symbol)	Proposed Cycle Path
(Symbol)	Proposed Fencing
(Symbol)	Proposed Driveway
(Symbol)	Proposed Footpath
(Symbol)	Proposed Boundary
(Symbol)	Proposed Wall
(Symbol)	Proposed Gate
(Symbol)	Proposed Gate Post
(Symbol)	Proposed Gate Pillar
(Symbol)	Proposed Gate Lintel
(Symbol)	Proposed Gate Post Cap
(Symbol)	Proposed Gate Pillar Cap
(Symbol)	Proposed Gate Lintel Cap
(Symbol)	Proposed Gate Post Foundation
(Symbol)	Proposed Gate Pillar Foundation
(Symbol)	Proposed Gate Lintel Foundation
(Symbol)	Proposed Gate Post Footing
(Symbol)	Proposed Gate Pillar Footing
(Symbol)	Proposed Gate Lintel Footing
(Symbol)	Proposed Gate Post Foundation
(Symbol)	Proposed Gate Pillar Foundation
(Symbol)	Proposed Gate Lintel Foundation
(Symbol)	Proposed Gate Post Footing
(Symbol)	Proposed Gate Pillar Footing
(Symbol)	Proposed Gate Lintel Footing

THIS PLAN MUST NOT BE ALTERED IN ANY WAY UNLESS  
AUTHORISED BY THE SENIOR LAND SURVEYOR  
ONLY AUTHENTICATED COPIES OF THIS PLAN SHOULD BE USED  
© COPYRIGHT - BERMUDA GOVERNMENT

