



Request for Proposal #2020-004P-MPW Supply  
and Delivery of Bulk Fuels and Infrastructure  
Upgrades

GOVERNMENT OF BERMUDA  
Ministry of Public Works

**Addendum #2**

August 20, 2020

Dear Respondents.

This Addendum supersedes information contained in the Request for Proposal ("RFP") to the extent referenced.

This Addendum forms part of the RFP documents and will be subject to all of the conditions set out in the contract conditions.

Addendum #2 contains five (5) pages.

**1. Additional drawings are provided as follows:**

- a. **BPS Headquarters Way Survey – Annex N**
- b. **DPT Palmetto Road Fuel Tanks – Annex O**
- c. **DPT Palmetto Road Site Survey Metric – Annex P**
- d. **M & P East Broadway Stamped Survey – Annex Q**
- e. **M & P East Broadway Survey Exploded.dwg – Annex R (Auto Cad DWG to be emailed)**

Best regards,

A handwritten signature in black ink, appearing to read 'Elizabeth Davis-Smith'.

Elizabeth Davis-Smith

**Assistant Purchasing and Supply Officer  
Ministry of Public Works**

**END OF ADDENDUM #2**

Page 1 of 5





Annex P

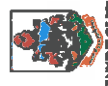
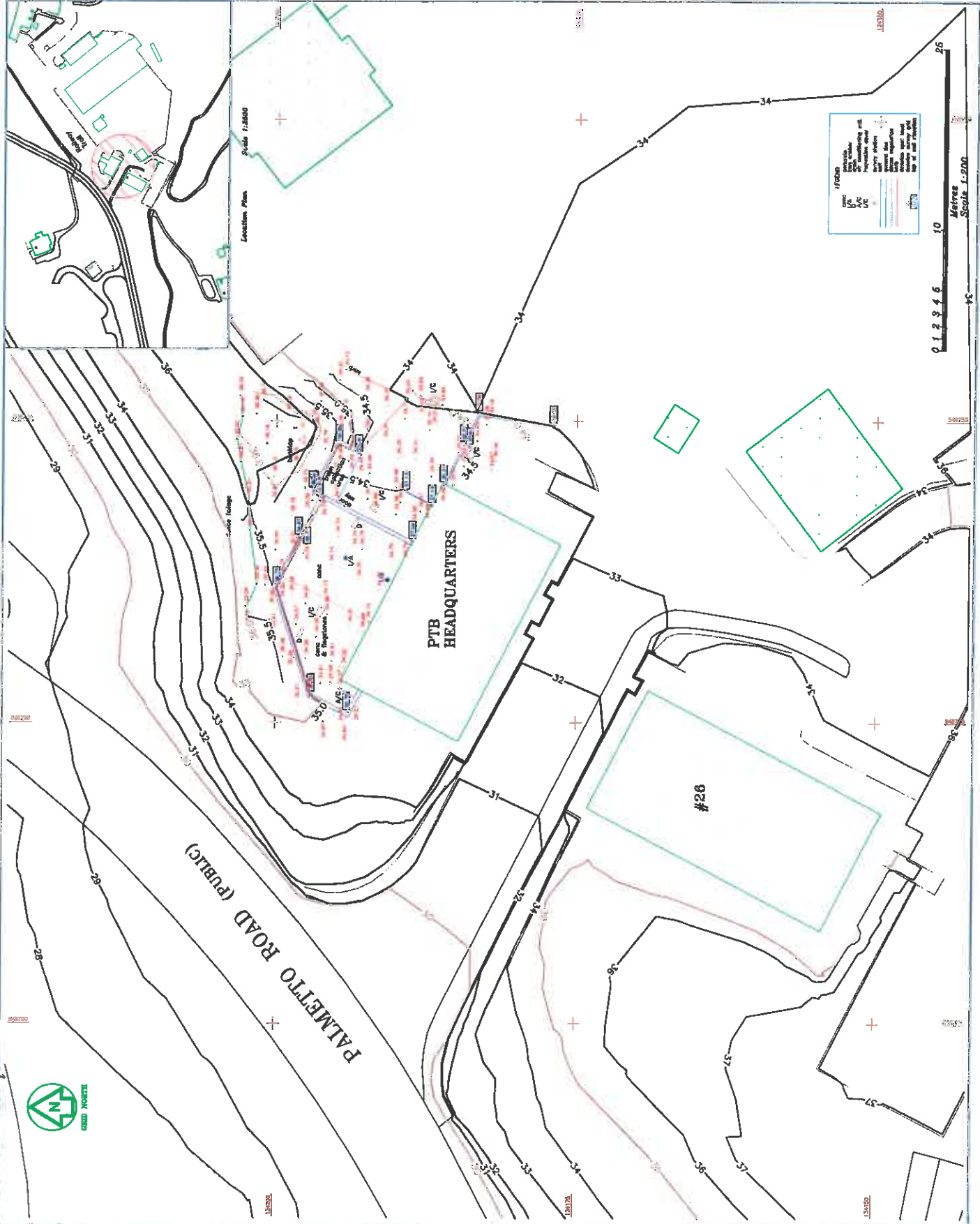

GOVERNMENT OF MANITOBA  
Ministry of Public Works

Department of Land Surveys & Registration  
P.O. Box 104144, Winnipeg R4X 1N9, Manitoba  
Phone: (416) 295-5151 Fax: (416) 295-5458

GENERAL NOTES:  
1. SURVEY GRID IS BINGHAM.  
2. DATUMS ARE IN METRES ABOVE ORIGIN.  
3. ROAD & BUILDING OUTLINES HOISTED FROM  
2015 TOPOGRAPHIC MAPPING DATABASE.

SURVEY STATION COORDINATES  
SIN EASTINGS NORTHINGS LEVEL  
1 540748.43 134197.87 38.20

THIS PLAN WAS PREPARED BY THE SURVEYOR  
AND APPROVED BY THE REGISTERED LAND SURVEYOR  
IN ACCORDANCE WITH THE SURVEY ACT AND REGULATIONS  
ISSUED FOR:

AMENDMENTS:

NO.	REVISION	APP.	DATE

SCALE: 1:200 METRIC

SURVEY  
PREPARED BY: C. SHANE MCILWAIN DATE: 08/02/17  
DESIGN  
PREPARED BY: S. PATTERSON DATE: 20/02/17  
CHECKED BY: S. PATTERSON DATE: 20/02/17  
APPROVED BY: S. PATTERSON - SENIOR LAND SURVEYOR  
PROJECT NUMBER: 30/241/33 TRS2410

### PTB PROPOSED ROOF REPAIRS

#26  
PALMETTO ROAD  
DEVONSHIRE  
DRAWING FILE NO: CML 30 2011  
PMS\SURVEY\PROJECTS\3024133\TR2410

### TOPOGRAPHIC SURVEY

SHEET NUMBER: 4834/008/03  
REVISION:

